

**Tri-City Extrusion, Inc.**

1610 Arkansas Avenue  
Bristol, TN 37620  
(Office) 866-242-9348  
(Fax) 866-242-9349

Description: American Standard Angle Equal Leg (ASAEL)

ASTM B308

Alloy: 6000 Series

| DEPOT NUMBER   | DIE NO. | DESCRIPTION   | A     | T     | R     | R1    | WT/FT. |
|----------------|---------|---------------|-------|-------|-------|-------|--------|
| ASAEL1000-0125 | 50113   | 1.000 X 1.000 | 1.000 | 0.125 | 0.125 | 0.094 | 0.275  |
|                | 50363   | 1.000 X 1.000 | 1.000 | 0.188 | 0.125 | 0.094 | 0.400  |
| ASAEL1000-0250 | 50158   | 1.000 X 1.000 | 1.000 | 0.250 | 0.125 | 0.094 | 0.514  |
|                | 50364   | 1.250 X 1.250 | 1.250 | 0.125 | 0.188 | 0.125 | 0.343  |
| ASAEL1250-0188 | 50159   | 1.250 X 1.250 | 1.250 | 0.188 | 0.188 | 0.125 | 0.510  |
| ASAEL1250-0250 | 862     | 1.250 X 1.250 | 1.250 | 0.250 | 0.188 | 0.125 | 0.656  |
| ASAEL1500-0125 | 50114   | 1.500 X 1.500 | 1.500 | 0.125 | 0.188 | 0.125 | 0.432  |
| ASAEL1500-0188 | 50130   | 1.500 X 1.500 | 1.500 | 0.188 | 0.188 | 0.125 | 0.619  |
| ASAEL1500-0250 | 50131   | 1.500 X 1.500 | 1.500 | 0.250 | 0.188 | 0.125 | 0.809  |
|                | 50365   | 1.750 X 1.750 | 1.750 | 0.250 | 0.188 | 0.125 | 0.956  |
| ASAEL2000-0125 | 50132   | 2.000 X 2.000 | 2.000 | 0.125 | 0.250 | 0.125 | 0.577  |
| ASAEL2000-0188 | 336     | 2.000 X 2.000 | 2.000 | 0.188 | 0.250 | 0.125 | 0.850  |
| ASAEL2000-0250 | 50116   | 2.000 X 2.000 | 2.000 | 0.250 | 0.250 | 0.125 | 1.110  |
| ASAEL2000-0375 | 50284   | 2.000 X 2.000 | 2.000 | 0.375 | 0.250 | 0.125 | 1.606  |
| ASAEL2500-0250 | 50169   | 2.500 X 2.500 | 2.500 | 0.250 | 0.125 | 0.250 | 1.404  |
|                | 50366   | 2.500 X 2.500 | 2.500 | 0.375 | 0.250 | 0.125 | 2.047  |
| ASAEL3000-0188 | 50274   | 3.000 X 3.000 | 3.000 | 0.188 | 0.313 | 0.250 | 1.275  |
| ASAEL3000-0250 | 50089   | 3.000 X 3.000 | 3.000 | 0.250 | 0.313 | 0.250 | 1.684  |
| ASAEL3000-0375 | 50133   | 3.000 X 3.000 | 3.000 | 0.375 | 0.313 | 0.250 | 2.474  |
| ASAEL4000-0250 | 50137   | 4.000 X 4.000 | 4.000 | 0.250 | 0.375 | 0.250 | 2.283  |
| ASAEL4000-0375 | 50117   | 4.000 X 4.000 | 4.000 | 0.375 | 0.375 | 0.250 | 3.366  |
|                | 51233   | 6.000 X 6.000 | 6.000 | 6.000 | 0.500 | 0.375 | 5.119  |

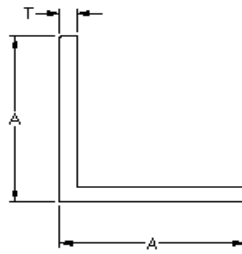

Description: Architectural Angle - Square Corners (AASC)      ASTM B221  
 Alloy: 6000 Series

| DEPOT NUMBER  | DIE NO. | DESCRIPTION        | A     | T     | WT/FT. |
|---------------|---------|--------------------|-------|-------|--------|
|               | 50971   | .750 X .750 X .188 | 0.750 | 0.188 | 0.290  |
|               | 101     | 0.937 X 0.937      | 0.937 | 0.050 | 1.080  |
|               | 105     | 1.000 X 1.000      | 1.000 | 0.060 | 0.136  |
|               | 312     | 1.000 X 1.000      | 1.000 | 0.085 | 0.191  |
|               | 136     | 1.000 X 1.000      | 1.000 | 0.125 | 0.275  |
|               | 252     | 1.250 X 1.250      | 1.250 | 0.188 | 0.512  |
|               | 111     | 1.500 X 1.500      | 1.500 | 0.050 | 0.175  |
|               | 299     | 1.500 X 1.500      | 1.500 | 0.118 | 0.400  |
| AASC1500-0125 | 50123   | 1.500 X 1.500      | 1.500 | 0.125 | 0.422  |
|               | 129     | 1.500 X 1.500      | 1.500 | 0.188 | 0.622  |
| AASC2000-0125 | 50138   | 2.000 X 2.000      | 2.000 | 0.125 | 0.569  |
| AASC2000-0188 | 50122   | 2.000 X 2.000      | 2.000 | 0.187 | 0.838  |
|               | 596     | 2.000 X 2.000      | 2.000 | 0.250 | 1.103  |

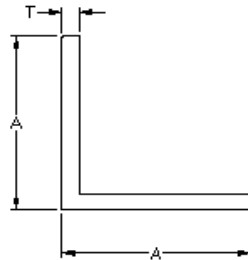

Description: Angle - Other      ASTM B221  
 Alloy: 6000 Series

| DEPOT NUMBER | DIE NO. | DESCRIPTION   | A     | T     | Tapered End | R     | WT/FT. |
|--------------|---------|---------------|-------|-------|-------------|-------|--------|
|              | 361     | 3.000 X 3.000 | 3.000 | 0.188 | N/A         | 0.250 | 1.286  |
|              | 369     | 3.000 X 3.000 | 3.000 | 0.250 | N/A         | 0.060 | 1.689  |

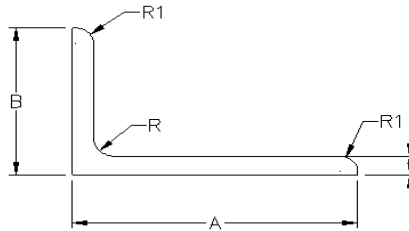

**Tri-City Extrusion, Inc.**

1610 Arkansas Avenue  
 Bristol, TN 37620  
 (Office) 866-242-9348  
 (Fax) 866-242-9349

Description: American Standard Angle Unequal Leg (ASAUE)  
 Alloy: 6000 Series (Structural)

ASTM B308

| DEPOT NUMBER  | DIE NO. | DESCRIPTION    | A     | B     | T     | R     | R1    | WT/FT. |
|---------------|---------|----------------|-------|-------|-------|-------|-------|--------|
| ASAUE215-0125 | 50121   | 2.000 X 1.500  | 2.000 | 1.500 | 0.125 | 0.188 | 0.125 | 0.496  |
| ASAUE215-0250 | 951     | 2.000 X 1.500  | 2.000 | 1.500 | 0.250 | 0.188 | 0.125 | 0.956  |
|               | 50246   | 2.5000 X 2.000 | 2.500 | 2.000 | 0.250 | 0.250 | 0.125 | 1.257  |
| ASAUE32-0250  | 50134   | 3.000 X 2.000  | 3.000 | 2.000 | 0.250 | 0.313 | 0.188 | 1.403  |
| ASAUE32-0375  | 50160   | 3.000 X 2.000  | 3.000 | 2.000 | 0.375 | 0.313 | 0.188 | 2.046  |
| ASAUE43-0250  | 50118   | 4.000 X 3.000  | 4.000 | 3.000 | 0.250 | 0.375 | 0.250 | 1.988  |
| ASAUE43-0375  | 50224   | 4.000 X 3.000  | 4.000 | 3.000 | 0.375 | 0.375 | 0.250 | 2.926  |
| ASAUE53-0375  | 50119   | 5.000 X 3.000  | 5.000 | 3.000 | 0.375 | 0.375 | 0.619 | 3.349  |
| ASAUE64-0375  | 50120   | 6.000 X 4.000  | 6.000 | 4.000 | 0.375 | 0.500 | 0.375 | 4.237  |

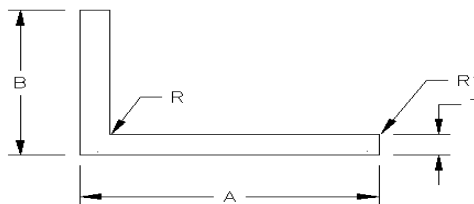

**Tri-City Extrusion, Inc.**

1610 Arkansas Avenue  
 Bristol, TN 37620  
 (Office) 866-242-9348  
 (Fax) 866-242-9349

Description: Architectural Angle Unequal Leg  
 Alloy: 6000 Series

ASTM B308

| DEPOT NUMBER | DIE NO. | DESCRIPTION   | A     | B     | T     | R     | R1    | WT/FT. |
|--------------|---------|---------------|-------|-------|-------|-------|-------|--------|
|              | 51021   | 2.000 X 1.000 | 2.000 | 1.000 | 0.125 | 0.015 | 0.015 | 0.422  |
|              | 51131   | 2.500 X 1.500 | 2.500 | 1.500 | 0.250 | 0.015 | 0.015 | 1.102  |
|              | 50003   | 3.000 X 2.000 | 3.000 | 2.000 | 0.125 | 0.015 | 0.015 | 0.716  |
|              | 50241   | 3.000 X 2.000 | 3.000 | 2.000 | 0.188 | 0.015 | 0.016 | 1.085  |
|              | 732     | 3.000 X 2.000 | 3.000 | 2.000 | 0.250 | 0.015 | 0.015 | 1.387  |
|              | 946     | 4.000 X 2.000 | 4.000 | 2.000 | 0.250 | 0.015 | 0.015 | 1.690  |
|              | 747     | 5.000 X 3.000 | 5.000 | 3.000 | 0.375 | 0.016 | 0.016 | 3.362  |

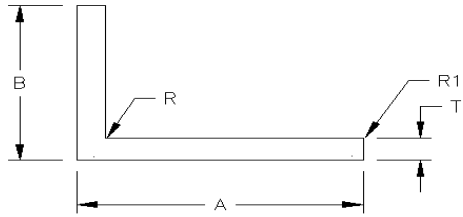

Description: Miscellaneous Angle Unequal Leg  
Alloy: 6000 Series

ASTM B308

| DEPOT NUMBER | DIE NO. | DESCRIPTION   | A     | B     | T     | R     | R1    | WT/FT. |
|--------------|---------|---------------|-------|-------|-------|-------|-------|--------|
|              | 952     | 4.000 X 3.000 | 4.000 | 3.000 | 0.250 | 0.015 | 0.375 | 2.012  |

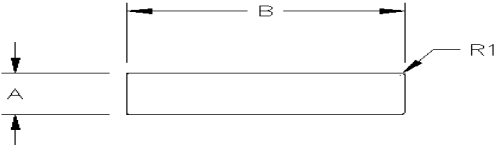

**Tri-City Extrusion, Inc.**

1610 Arkansas Avenue  
 Bristol, TN 37620  
 (Office) 866-242-9348  
 (Fax) 866-242-9349

Description: Flat Bar (FB)  
 Alloy: 6000 Series

ASTM B221

| Depot Number | DIE NO. | DESCRIPTION    | A     | B      | R1    | WT/FT. |
|--------------|---------|----------------|-------|--------|-------|--------|
|              | 51011   | 0.070 X 1.125  | 0.070 | 1.125  | 0.015 | 0.092  |
| FB0125-1000  | 354     | 0.125 X 1.000  | 0.125 | 1.000  | 0.015 | 0.147  |
|              | 50856   | 0.125 X 1.125  | 0.125 | 1.125  | 0.016 | 0.165  |
|              | 50448   | 0.125 X 1.500  | 0.125 | 1.500  | 0.016 | 0.220  |
| FB0125-2000  | 50226   | 0.125 X 2.000  | 0.125 | 2.000  | 0.015 | 0.294  |
|              | 50855   | 0.125 X 3.000  | 0.125 | 3.000  | 0.016 | 0.441  |
| FB0188-1000  | 884     | 0.188 X 1.000  | 0.188 | 1.000  | 0.016 | 0.220  |
| FB0188-1500  | 50153   | 0.188 X 1.500  | 0.188 | 1.500  | 0.016 | 0.330  |
| FB0188-2000  | 205     | 0.188 X 2.000  | 0.188 | 2.000  | 0.015 | 0.440  |
|              | 890     | 0.188 X 2.250  | 0.188 | 2.250  | 0.016 | 0.496  |
|              | 50841   | 0.188 X 4.000  | 0.188 | 4.000  | 0.016 | 0.884  |
| FB0188-2500  | 868     | 0.190 X 2.500  | 0.190 | 2.500  | 0.016 | 0.559  |
|              | 869     | 0.190 X 2.875  | 0.190 | 2.875  | 0.016 | 0.642  |
| FB0188-3000  | 970     | 0.190 X 3.000  | 0.190 | 3.000  | 0.016 | 0.670  |
| FB0250-0750  | 50163   | 0.250 X 0.750  | 0.250 | 0.750  | 0.016 | 0.220  |
| FB0250-1000  | 649     | 0.250 X 1.000  | 0.250 | 1.000  | 0.015 | 0.293  |
|              | 50833   | 0.250 X 1.250  | 0.250 | 1.250  | 0.016 | 0.368  |
| FB0250-1500  | 194     | 0.250 X 1.500  | 0.250 | 1.500  | 0.010 | 0.441  |
| FB0250-2000  | 182     | 0.250 X 2.000  | 0.250 | 2.000  | 0.015 | 0.588  |
| FB0250-2500  | 50212   | 0.250 X 2.500  | 0.250 | 2.500  | 0.016 | 0.735  |
|              | 335     | 0.250 X 2.500  | 0.250 | 2.500  | 0.125 | 0.719  |
| FB0250-3000  | 377     | 0.250 X 3.000  | 0.250 | 3.000  | 0.015 | 0.882  |
| FB0250-3500  | 50262   | 0.250 X 3.500  | 0.250 | 3.500  | 0.016 | 1.029  |
|              | 870     | 0.250 X 3.750  | 0.250 | 3.750  | 0.016 | 1.102  |
| FB0250-4000  | 342     | 0.250 X 4.000  | 0.250 | 4.000  | 0.015 | 1.176  |
|              | 867     | 0.250 X 4.750  | 0.250 | 4.750  | 0.016 | 1.396  |
| FB0250-5000  | 50242   | 0.250 X 5.000  | 0.250 | 5.000  | 0.016 | 1.470  |
| FB0250-6000  | 731     | 0.250 X 6.000  | 0.250 | 6.000  | 0.015 | 1.764  |
| FB0250-8000  | 50102   | 0.250 X 8.000  | 0.250 | 8.000  | 0.016 | 2.352  |
| FB0250-12000 | 50105   | 0.250 X 12.000 | 0.250 | 12.000 | 0.016 | 3.528  |

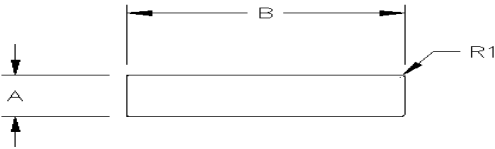

**Tri-City Extrusion, Inc.**

1610 Arkansas Avenue  
 Bristol, TN 37620  
 (Office) 866-242-9348  
 (Fax) 866-242-9349

Description: Flat Bar (FB)  
 Alloy: 6000 Series

ASTM B221

| Depot Number | DIE NO. | DESCRIPTION    | A     | B      | R1    | WT/FT. |
|--------------|---------|----------------|-------|--------|-------|--------|
|              | 50368   | 0.375 X 1.000  | 0.375 | 1.000  | 0.016 | 0.441  |
| FB0375-1250  | 735     | 0.375 X 1.250  | 0.375 | 1.250  | 0.015 | 0.552  |
|              | 50168   | 0.375 X 1.375  | 0.375 | 1.375  | 0.188 | 0.570  |
| FB0375-1500  | 734     | 0.375 X 1.500  | 0.375 | 1.500  | 0.015 | 0.661  |
| FB0375-2000  | 987     | 0.375 X 2.000  | 0.375 | 2.000  | 0.016 | 0.882  |
|              | 50088   | 0.375 X 2.375  | 0.375 | 2.375  | 0.016 | 1.047  |
| FB0375-2500  | 988     | 0.375 X 2.500  | 0.375 | 2.500  | 0.016 | 1.102  |
| FB0375-3000  | 989     | 0.375 X 3.000  | 0.375 | 3.000  | 0.016 | 1.323  |
|              | 505     | 0.375 X 3.750  | 0.375 | 3.750  | 0.016 | 1.653  |
| FB0375-4000  | 730     | 0.375 X 4.000  | 0.375 | 4.000  | 0.015 | 1.764  |
|              | 50857   | 0.375 X 4.500  | 0.375 | 4.500  | 0.016 | 1.984  |
|              | 50834   | 0.375 X 5.000  | 0.375 | 5.000  | 0.016 | 2.205  |
| FB0375-6000  | 50101   | 0.375 X 6.000  | 0.375 | 6.000  | 0.016 | 2.646  |
|              | 50840   | 0.375 X 10.000 | 0.375 | 10.000 | 0.016 | 4.410  |
| FB0375-12000 | 990     | 0.375 X 12.000 | 0.375 | 12.000 | 0.016 | 52.920 |
| FB0500-1000  | 50207   | 0.500 X 1.000  | 0.500 | 1.000  | 0.016 | 0.588  |
| FB0500-1500  | 50139   | 0.500 X 1.500  | 0.500 | 1.500  | 0.016 | 0.882  |
| FB0500-2000  | 245     | 0.500 X 2.000  | 0.500 | 2.000  | 0.015 | 1.176  |
|              | 50433   | 0.500 X 2.500  | 0.500 | 2.500  | 0.016 | 1.470  |
|              | 234     | 0.500 X 3.000  | 0.500 | 3.000  | 0.062 | 1.764  |
| FB0500-3000  | 50106   | 0.500 X 3.000  | 0.500 | 3.000  | 0.016 | 1.764  |
| FB0500-4000  | 50099   | 0.500 X 4.000  | 0.500 | 4.000  | 0.016 | 2.352  |
| FB0500-5000  | 50098   | 0.500 X 5.000  | 0.500 | 5.000  | 0.016 | 2.940  |
| FB0500-6000  | 50042   | 0.500 X 6.000  | 0.500 | 6.000  | 0.016 | 3.528  |
| FB0500-7000  | 50266   | 0.500 X 7.000  | 0.500 | 7.000  | 0.016 | 4.116  |
| FB0500-8000  | 50148   | 0.500 X 8.000  | 0.500 | 8.000  | 0.016 | 4.704  |
| FB0500-9000  | 50149   | 0.500 X 9.000  | 0.500 | 9.000  | 0.016 | 5.292  |
| FB0500-10000 | 50103   | 0.500 X 10.000 | 0.500 | 10.000 | 0.016 | 5.880  |
| FB0500-12000 | 50104   | 0.500 X 12.000 | 0.500 | 12.000 | 0.016 | 7.056  |
| FB0625-5000  | 50209   | 0.625 X 5.000  | 0.625 | 5.000  | 0.016 | 3.675  |

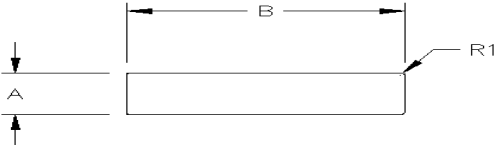

**Tri-City Extrusion, Inc.**

1610 Arkansas Avenue  
Bristol, TN 37620  
(Office) 866-242-9348  
(Fax) 866-242-9349

Description: Flat Bar (FB)  
Alloy: 6000 Series

ASTM B221

| Depot Number | DIE NO. | DESCRIPTION    | A     | B      | R1    | WT/FT. |
|--------------|---------|----------------|-------|--------|-------|--------|
| FB0750-1000  | 670     | 0.750 X 1.000  | 0.750 | 1.000  | 0.016 | 0.882  |
|              | 50492   | 0.750 X 1.250  | 0.750 | 1.250  | 0.016 | 1.102  |
| FB0750-1500  | 50283   | 0.750 X 1.500  | 0.750 | 1.500  | 0.016 | 1.323  |
| FB0750-2000  | 611     | 0.750 X 2.000  | 0.750 | 2.000  | 0.015 | 1.764  |
|              | 50369   | 0.750 X 3.000  | 0.750 | 3.000  | 0.016 | 2.646  |
|              | 50370   | 0.750 X 4.000  | 0.750 | 4.000  | 0.016 | 3.528  |
| FB750-6000   | 50154   | 0.750 X 6.000  | 0.750 | 6.000  | 0.016 | 5.292  |
|              | 50839   | 0.750 X 12.000 | 0.750 | 12.000 | 0.016 | 10.284 |
|              | 50040   | 0.875 x 8.000  | 0.875 | 8.000  | 0.016 | 8.232  |
| FB1000-1500  | 50041   | 1.000 X 1.500  | 1.000 | 1.500  | 0.016 | 1.764  |
| FB1000-2000  | 50100   | 1.000 X 2.000  | 1.000 | 2.000  | 0.016 | 2.352  |
| FB1000-2500  | 50156   | 1.000 X 2.500  | 1.000 | 2.500  | 0.016 | 2.940  |
|              | 50367   | 1.000 X 3.000  | 1.000 | 3.000  | 0.016 | 3.528  |
|              | 50438   | 1.000 X 4.000  | 1.000 | 4.000  | 0.016 | 4.704  |
|              | 50198   | 1.000 X 5.000  | 1.000 | 5.000  | 0.016 | 5.880  |
| FB1000-6000  | 982     | 1.000 X 6.000  | 1.000 | 6.000  | 0.016 | 7.056  |
| FB1000-7000  | 50150   | 1.000 X 7.000  | 1.000 | 7.000  | 0.016 | 8.232  |
| FB1000-8000  | 976     | 1.000 X 8.000  | 1.000 | 8.000  | 0.016 | 9.408  |
| FB1000-8500  | 50151   | 1.000 X 8.500  | 1.000 | 8.500  | 0.016 | 9.996  |
| FB1000-9250  | 50152   | 1.000 X 9.250  | 1.000 | 9.250  | 0.016 | 10.878 |
| FB1000-10000 | 50161   | 1.000 X 10.000 | 1.000 | 10.000 | 0.016 | 11.760 |
| FB1000-12000 | 50162   | 1.000 X 12.000 | 1.000 | 12.000 | 0.016 | 14.112 |
|              | 50238   | 1.250 X 2.500  | 1.250 | 2.500  | 0.016 | 3.675  |
|              | 50417   | 1.250 X 2.500  | 1.250 | 2.500  | 0.016 | 3.675  |
| FB1500-2000  | 50166   | 1.500 X 2.000  | 1.500 | 2.000  | 0.016 | 3.528  |
|              | 50234   | 1.500 X 2.500  | 1.500 | 2.500  | 0.016 | 4.410  |
|              | 50416   | 1.500 X 2.500  | 1.500 | 2.500  | 0.016 | 4.410  |
| FB2000-3000  | 50107   | 2.000 X 3.000  | 2.000 | 3.000  | 0.016 | 7.056  |
|              | 51189   | 1.151 X 4.000  | 1.151 | 4.000  | 0.031 | 7.102  |
|              | 50376   | 2.000 X 4.000  | 2.000 | 4.000  | 0.016 | 9.408  |
|              | 50204   | 3.000 X 4.000  | 3.000 | 4.000  | 0.016 | 14.112 |

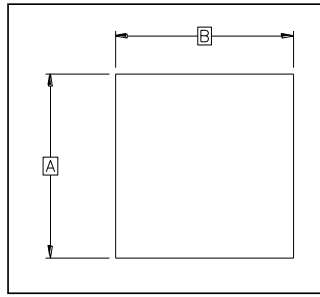

**Tri-City Extrusion, Inc.**

1610 Arkansas Avenue  
Bristol, TN 37620  
(Office) 866-242-9348  
(Fax) 866-242-9349

Description: Solid Square Bar  
Alloy: 6000 Series

ASTM B221

| DIE NO. | DESCRIPTION | A     | B     | WT/FT. |
|---------|-------------|-------|-------|--------|
| 773     | 0.375       | 0.375 | 0.375 | 0.166  |
| 771     | 0.500       | 0.500 | 0.500 | 0.250  |
| 696     | 0.625       | 0.625 | 0.625 | 0.460  |
| 772     | 0.875       | 0.875 | 0.875 | 0.900  |
| 769     | 1.000       | 1.000 | 1.000 | 1.176  |
| 51199   | 1.250       | 1.250 | 1.250 | 1.837  |
| 50227   | 1.500       | 1.500 | 1.500 | 2.671  |
| 50205   | 2.000       | 2.000 | 2.000 | 4.760  |
| 50206   | 3.000       | 3.000 | 3.000 | 10.669 |



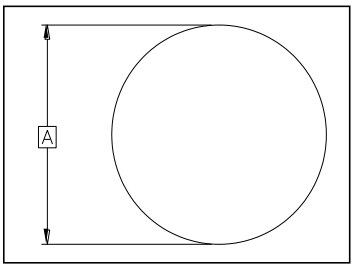

**Tri-City Extrusion, Inc.**  
 1610 Arkansas Avenue  
 Bristol, TN 37620  
 (Office) 866-242-9348  
 (Fax) 866-242-9349

Description: Round Rod (RR)  
 Alloy: 6000 Series

Item In Red Only Available IN 6063 Alloy

ASTM B221  
 1/2 Commerical Tolerance

| Depot Number | DIE NO. | DESCRIPTION | A     | Tolerance (+/-) | WT/FT. |
|--------------|---------|-------------|-------|-----------------|--------|
|              | 692     | 0.250       | 0.250 | 0.004           | 0.058  |
|              | 122     | 0.312       | 0.312 | 0.004           | 0.091  |
| RR0375       | 886     | 0.375       | 0.375 | 0.004           | 0.132  |
|              | 727     | 0.394       | 0.394 | 0.004           | 0.143  |
| RR0500       | 344     | 0.500       | 0.500 | 0.005           | 0.230  |
| RR0625       | 334     | 0.625       | 0.625 | 0.005           | 0.361  |
| RR0750       | 689     | 0.750       | 0.750 | 0.005           | 0.520  |
| RR0875       | 368     | 0.875       | 0.875 | 0.005           | 0.707  |
| RR1000       | 664     | 1.000       | 1.000 | 0.006           | 0.923  |
| RR1125       | 50231   | 1.125       | 1.125 | 0.006           | 1.169  |
| RR1250       | 669     | 1.250       | 1.250 | 0.006           | 1.473  |
| RR1375       | 854     | 1.375       | 1.375 | 0.006           | 1.7460 |
|              | 50822   | 1.382       | 1.382 | 0.006           | 1.7640 |
| RR1500       | 829     | 1.500       | 1.500 | 0.007           | 2.078  |
| RR1750       | 50165   | 1.750       | 1.750 | 0.007           | 2.828  |
|              | 50497   | 1.875       | 1.875 | 0.007           | 3.247  |
| RR2000       | 778     | 2.000       | 2.000 | 0.012           | 3.695  |
|              | 50498   | 2.250       | 2.250 | 0.012           | 4.676  |
|              | 50891   | 2.250       | 2.250 | 0.024           | 4.676  |
| RR2500       | 50285   | 2.500       | 2.500 | 0.012           | 5.773  |
| RR2750       | 50499   | 2.750       | 2.750 | 0.012           | 6.985  |
| RR3000       | 50203   | 3.000       | 3.000 | 0.012           | 8.379  |
| RR4000       | 50125   | 4.000       | 4.000 | 0.017           | 14.778 |

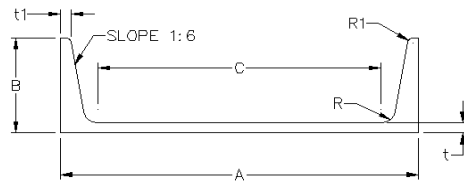

**Tri-City Extrusion, Inc.**

1610 Arkansas Avenue  
 Bristol, TN 37620  
 (Office) 866-242-9348  
 (Fax) 866-242-9349

Description: American Standard Channel (ASC)  
 Alloy: 6000 Series

ASTM B308  
 6061 Stenciled

| DEPOT NUMBER   | DIE NO. | DESCRIPTION    | A      | B     | T     | T1    | R     | R1    | WT/FT. |
|----------------|---------|----------------|--------|-------|-------|-------|-------|-------|--------|
| ASC31410-0170  | 932     | 3.000 X 1.410  | 3.000  | 1.410 | 0.170 | 0.170 | 0.270 | 0.100 | 1.417  |
| ASC31498-0258  | 50111   | 3.000 X 1.498  | 3.000  | 1.498 | 0.258 | 0.170 | 0.270 | 0.100 | 1.729  |
| ASC41580-0180  | 50109   | 4.000 X 1.580  | 4.000  | 1.580 | 0.180 | 0.180 | 0.280 | 0.110 | 1.846  |
| ASC41647-0247  | 50110   | 4.000 X 1.647  | 4.000  | 1.647 | 0.247 | 0.180 | 0.280 | 0.110 | 2.161  |
| ASC41720-0320  | 50404   | 4.000 X 1.720  | 4.000  | 1.720 | 0.320 | 0.180 | 0.280 | 0.110 | 2.504  |
|                | 50437   | 5.000 X 1.750  | 5.000  | 1.750 | 0.190 | 0.190 | 0.290 | 0.110 | 2.316  |
| ASC51885-0325  | 50286   | 5.000 X 1.885  | 5.000  | 1.885 | 0.325 | 0.190 | 0.290 | 0.110 | 3.108  |
| ASC6192-0200   | 50135   | 6.000 X 1.920  | 6.000  | 1.920 | 0.200 | 0.200 | 0.300 | 0.120 | 2.826  |
| ASC61945-0225  | 896     | 6.000 X 1.945  | 6.000  | 1.945 | 0.225 | 0.200 | 0.619 | 0.120 | 3.002  |
|                | 635     | 6.000 X 2.150  | 6.000  | 2.150 | 0.450 | 0.200 | 0.300 | 0.120 | 4.293  |
|                | 895     | 7.000 X 2.110  | 7.000  | 2.110 | 0.230 | 0.210 | 0.310 | 0.130 | 3.541  |
| ASC82290-0250  | 50112   | 8.000 X 2.290  | 8.000  | 2.290 | 0.250 | 0.220 | 0.320 | 0.130 | 4.252  |
| ASC82527-0487  | 50268   | 8.000 X 2.527  | 8.000  | 2.527 | 0.487 | 0.220 | 0.320 | 0.130 | 6.484  |
| ASC122960-0300 | 50164   | 12.000 X 2.960 | 12.000 | 2.960 | 0.300 | 0.280 | 0.380 | 0.170 | 7.411  |
| ASC123170-0510 | 50167   | 12.000 X 3.170 | 12.000 | 3.170 | 0.510 | 0.280 | 0.380 | 0.170 | 10.374 |

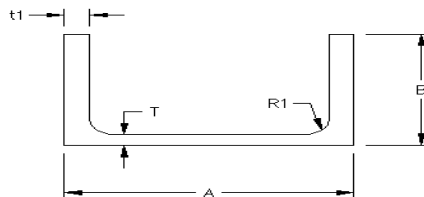

Description: Aluminum Association  
 Alloy: 6000 Series

ASTM B308  
 6061 Stenciled

| DEPOT NUMBER  | DIE NO. | DESCRIPTION   | A     | B     | T     | T1    | R1    | WT/FT. |
|---------------|---------|---------------|-------|-------|-------|-------|-------|--------|
| AAC25150-0190 | 51161   | 2.500 X 1.500 | 2.500 | 1.500 | 0.190 | 0.260 | 0.200 | 1.379  |
| AAC31500-0130 | 50405   | 3.000 X 1.500 | 3.000 | 1.500 | 0.130 | 0.200 | 0.250 | 1.135  |
| AAC31750-0170 | 339     | 3.000 X 1.750 | 3.000 | 1.750 | 0.170 | 0.260 | 0.250 | 1.597  |
| AAC42000-0150 | 50288   | 4.000 X 2.000 | 4.000 | 2.000 | 0.150 | 0.230 | 0.250 | 1.738  |
| AAC62500-0170 | 51154   | 6.000 X 2.500 | 6.000 | 2.500 | 0.170 | 0.290 | 0.300 | 2.834  |
| AAC63250-0210 | 50155   | 6.000 X 3.250 | 6.000 | 3.250 | 0.210 | 0.350 | 0.300 | 4.030  |
| AAC83000-0190 | 50287   | 8.000 X 3.000 | 8.000 | 3.000 | 0.190 | 0.350 | 0.300 | 4.147  |
| AAC83750-0250 | 50289   | 8.000 X 3.750 | 8.000 | 3.750 | 0.250 | 0.410 | 0.350 | 5.789  |

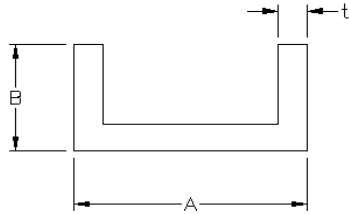

**Tri-City Extrusion, Inc.**

1610 Arkansas Avenue  
Bristol, TN 37620  
(Office) 866-242-9348  
(Fax) 866-242-9349

Description: Sharp Corner Channel (SCC)  
Alloy: 6000 Series

ASTM B308

| DEPOT | DIE NO. | DESCRIPTION   | A     | B     | T     | WT/FT. |
|-------|---------|---------------|-------|-------|-------|--------|
|       | 50011   | 1.00 X 0.500  | 1.000 | 0.500 | 0.125 | 0.263  |
|       | 684     | 1.00 X 1.000  | 1.000 | 1.000 | 0.125 | 0.412  |
|       | 50091   | 1.00 X 1.500  | 1.000 | 1.500 | 0.125 | 0.563  |
|       | 50854   | 1.250 X 0.500 | 1.250 | 0.500 | 0.125 | 0.294  |
|       | 50124   | 1.500 X 1.000 | 1.500 | 1.000 | 0.125 | 0.487  |
|       | 941     | 1.750 X 1.000 | 1.750 | 1.000 | 0.125 | 0.524  |
|       | 50010   | 2.000 X 1.000 | 2.000 | 1.000 | 0.125 | 0.563  |
|       | 51169   | 2.500 X 1.500 | 2.500 | 1.500 | 0.125 | 0.771  |
|       | 947     | 4.250 X 1.000 | 4.250 | 1.000 | 0.100 | 0.724  |
|       | 848     | 5.000 X 1.000 | 5.000 | 1.000 | 0.125 | 1.013  |
|       | 873     | 5.000 X 2.000 | 5.000 | 2.000 | 0.188 | 1.945  |
|       | 675     | 6.531 X 3.290 | 6.614 | 3.290 | 0.250 | 3.760  |

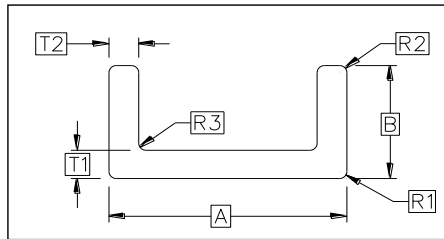

**Tri-City Extrusion, Inc.**

1610 Arkansas Avenue  
Bristol, TN 37620  
(Office) 866-242-9348  
(Fax) 866-242-9349

Description: Miscellaneous Equal Leg Channel  
Alloy: 6000 Series

ASTM B221

| DEPOT NUMBER | DIE NO. | DESCRIPTION   | A     | B     | T1    | T2    | R1    | R2    | R3    | WT/FT. |
|--------------|---------|---------------|-------|-------|-------|-------|-------|-------|-------|--------|
|              | 300     | 1.372 X 1.375 | 1.372 | 1.375 | 0.060 | 0.060 | 0.025 | FULL  | 0.016 | 0.288  |
|              | 301     | 1.375 X 1.500 | 1.375 | 1.500 | 0.060 | 0.060 | 0.025 | FULL  | 0.015 | 0.315  |
|              | 360     | 2.375 X 1.688 | 2.375 | 1.688 | 0.188 | 0.188 | 0.250 | 0.020 | 0.062 | 1.215  |
|              | 50222   | 2.500 X 0.750 | 2.500 | 0.750 | 0.125 | 0.125 | 0.125 | 0.016 | 0.016 | 0.563  |
|              | 860     | 2.500 X 1.063 | 2.500 | 1.063 | 0.188 | 0.125 | 0.125 | 0.016 | 0.016 | 0.817  |
|              | 683     | 2.750 X 2.750 | 2.750 | 2.750 | 0.100 | 0.100 | 0.125 | 0.016 | 0.025 | 0.958  |
|              | 932     | 3.000 X 1.410 | 3.000 | 1.410 | 0.170 | 0.170 | 0.016 | 0.016 | 0.270 | 1.417  |
|              | 339     | 3.000 X 1.750 | 3.000 | 1.750 | 0.170 | 0.260 | 0.031 | 0.016 | 0.250 | 1.673  |
|              | 212     | 4.000 X 1.750 | 4.000 | 1.750 | 0.250 | 0.250 | 0.016 | 0.016 | 0.150 | 2.112  |
|              | 115     | 4.000 X 2.000 | 4.000 | 2.000 | 0.150 | 0.150 | 0.010 | 0.010 | 0.250 | 1.774  |
|              | 636     | 5.000 X 1.885 | 5.000 | 1.885 | 0.325 | 0.190 | 0.016 | 0.110 | 0.290 | 2.898  |
|              | 896     | 6.000 X 1.945 | 6.000 | 1.945 | 0.225 | 0.200 | 0.016 | 0.120 | 0.300 | 2.981  |
|              | 895     | 7.000 X 2.110 | 7.000 | 2.110 | 0.230 | 0.210 | 0.106 | 0.130 | 0.310 | 3.516  |

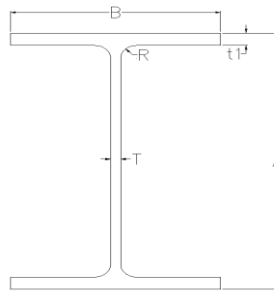

**Tri-City Extrusion, Inc.**

1610 Arkansas Avenue  
Bristol, TN 37620  
(Office) 866-242-9348  
(Fax) 866-242-9349

Description: Aluminum Association I Beam  
Alloy: 6000 Series

ASTM B308  
6061 Stenciled

| DIE NO. | DESCRIPTION | A      | B     | T     | T1    | R     | WT/FT. |
|---------|-------------|--------|-------|-------|-------|-------|--------|
| 50269   | 6.000       | 6.000  | 4.000 | 0.190 | 0.290 | 0.300 | 4.030  |
| 50257   | 6.000       | 6.000  | 4.000 | 0.210 | 0.350 | 0.300 | 4.692  |
| 50271   | 8.000       | 8.000  | 5.000 | 0.230 | 0.350 | 0.300 | 6.181  |
| 50272   | 8.000       | 8.000  | 5.000 | 0.250 | 0.410 | 0.300 | 7.023  |
| 51234   | 8.000       | 8.000  | 8.000 | 0.288 | 0.433 | 0.400 | 10.725 |
| 50323   | 10.000      | 10.000 | 6.000 | 0.250 | 0.410 | 0.400 | 8.646  |
| 50330   | 10.000      | 10.000 | 6.000 | 0.290 | 0.500 | 0.400 | 10.286 |

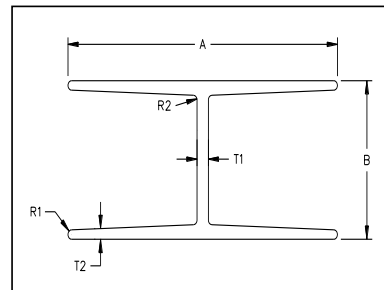

Description: Miscellaneous I Beam  
Alloy: 6000 Series

ASTM B221

| DIE NO. | DESCRIPTION | A     | B     | T1    | T2    | R1    | R2    | WT/FT. |
|---------|-------------|-------|-------|-------|-------|-------|-------|--------|
| 407     | 3.000       | 2.330 | 3.000 | 0.170 | 0.197 | 0.125 | 0.256 | 1.963  |
| 567     | 3.750       | 3.000 | 3.750 | 0.175 | 0.250 | 0.125 | 0.250 | 2.516  |
| 458     | 3.750       | 3.750 | 3.750 | 0.115 | 0.115 | 0.016 | 0.016 | 1.560  |
| 592     | 4.000       | 1.250 | 4.000 | 0.150 | 0.188 | 0.062 | 0.250 | 1.722  |
| 583     | 4.000       | 2.250 | 4.000 | 0.100 | 0.100 | FULL  | 0.125 | 1.158  |
| 50060   | 5.000       | 2.813 | 5.000 | 0.200 | 0.200 | 0.070 | 0.281 | 3.199  |
| 408     | 5.000       | 3.000 | 5.000 | 0.214 | 0.210 | 0.125 | 0.313 | 3.799  |
| 831     | 6.125       | 4.375 | 6.125 | 0.500 | 0.529 | 0.362 | 0.290 | 9.587  |

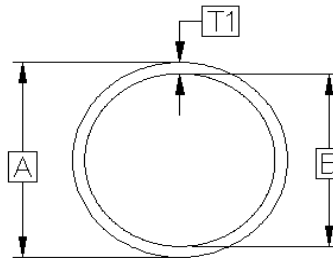

**Tri-City Extrusion, Inc.**

1610 Arkansas Avenue  
Bristol, TN 37620  
(Office) 866-242-9348  
(Fax) 866-242-9349

Description: Schedule Pipe (P)  
Alloy: 6000 Series

ASTM B429

| Depot Number | DIE NO. | DESCRIPTION   | OD A  | ID B  | WALL T1 | 6063 | 6061  | WT/FT. |
|--------------|---------|---------------|-------|-------|---------|------|-------|--------|
|              | 2799    | 0.250 SCH. 40 | 0.540 | 0.364 | 0.088   | X    |       | 0.147  |
|              | 2488    | 0.500 SCH. 40 | 0.840 | 0.622 | 0.109   | X    |       | 0.294  |
| P0750-63     | 1160    | 0.750 SCH. 40 | 1.050 | 0.824 | 0.113   | X    |       | 0.391  |
| P1000-63     | 1008    | 1.000 SCH. 40 | 1.315 | 1.049 | 0.125   | X    |       | 0.581  |
| P1000-61     | 1008    | 1.000 SCH. 40 | 1.315 | 1.049 | 0.125   |      | X     | 0.581  |
|              | 1163    | 1.250 SCH. 10 | 1.660 | 1.442 | 0.109   | X    |       | 0.625  |
|              | 1163    | 1.250 SCH. 10 | 1.660 | 1.442 | 0.109   |      | 0.619 | 0.625  |
| P1250-63     | 1017    | 1.250 SCH. 40 | 1.660 | 1.380 | 0.140   | X    |       | 0.786  |
| P1250-61     | 1017    | 1.250 SCH. 40 | 1.660 | 1.380 | 0.140   |      | X     | 0.786  |
|              | 1186    | 1.500 SCH. 10 | 1.900 | 1.682 | 0.109   | X    |       | 0.721  |
|              | 1186    | 1.500 SCH. 10 | 1.900 | 1.682 | 0.109   |      | X     | 0.721  |
| P1500-63     | 1091    | 1.500 SCH. 40 | 1.900 | 1.610 | 0.145   | X    |       | 0.940  |
| P1500-61     | 1091    | 1.500 SCH. 40 | 1.900 | 1.610 | 0.145   |      | X     | 0.940  |
|              | 2372    | 1.500 SCH. 80 | 1.900 | 1.500 | 0.200   | X    |       | 1.256  |
|              | 2372    | 1.500 SCH. 80 | 1.900 | 1.500 | 0.200   |      | X     | 1.256  |
|              | 1187    | 2.000 SCH. 5  | 2.375 | 2.245 | 0.065   | X    |       | 0.555  |
|              | 1187    | 2.000 SCH. 5  | 2.375 | 2.245 | 0.065   |      | X     | 0.555  |
|              | 1128    | 2.000 SCH. 10 | 2.375 | 2.157 | 0.109   | X    |       | 0.913  |
|              | 1128    | 2.000 SCH. 10 | 2.375 | 2.157 | 0.109   |      | X     | 0.913  |
| P2000-63     | 1092    | 2.000 SCH. 40 | 2.375 | 2.067 | 0.154   | X    |       | 1.264  |
| P2000-61     | 1092    | 2.000 SCH. 40 | 2.375 | 2.067 | 0.154   |      | X     | 1.264  |
|              | 1139    | 2.000 SCH. 80 | 2.375 | 1.939 | 0.218   | X    |       | 1.737  |
|              | 1139    | 2.000 SCH. 80 | 2.375 | 1.939 | 0.218   |      | X     | 1.737  |
|              | 1188    | 2.500 SCH. 5  | 2.875 | 2.709 | 0.083   | X    |       | 0.856  |
|              | 1188    | 2.500 SCH. 5  | 2.875 | 2.709 | 0.083   |      | X     | 0.856  |
|              | 1158    | 2.500 SCH. 10 | 2.875 | 2.635 | 0.120   | X    |       | 1.221  |
|              | 1158    | 2.500 SCH. 10 | 2.875 | 2.635 | 0.120   |      | X     | 1.221  |
| P2500-63     | 1157    | 2.500 SCH. 40 | 2.875 | 2.469 | 0.203   | X    |       | 2.004  |
| P2500-61     | 1157    | 2.500 SCH. 40 | 2.875 | 2.469 | 0.203   |      | X     | 2.004  |
|              | 1072    | 2.500 SCH. 80 | 2.875 | 2.323 | 0.276   | X    |       | 2.650  |
|              | 1072    | 2.500 SCH. 80 | 2.875 | 2.323 | 0.276   |      | X     | 2.650  |

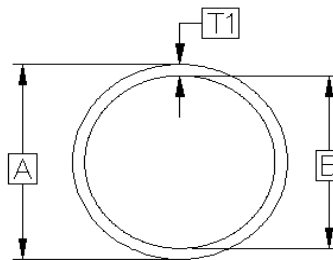

**Tri-City Extrusion, Inc.**  
1610 Arkansas Avenue  
Bristol, TN 37620  
(Office) 866-242-9348  
(Fax) 866-242-9349

Description: Schedule Pipe (P)  
Alloy: 6000 Series

ASTM B429

| Depot Number | DIE NO. | DESCRIPTION   | OD A  | ID B  | WALL T1 | 6063 | 6061 | WT/FT. |
|--------------|---------|---------------|-------|-------|---------|------|------|--------|
|              | 1130    | 3.000 SCH. 5  | 3.500 | 3.334 | 0.083   | X    |      | 1.048  |
|              | 1130    | 3.000 SCH. 5  | 3.500 | 3.334 | 0.083   |      | X    | 1.048  |
|              | 1129    | 3.000 SCH. 10 | 3.500 | 3.260 | 0.120   | X    |      | 1.498  |
|              | 1129    | 3.000 SCH. 10 | 3.500 | 3.260 | 0.120   |      | X    | 1.498  |
| P3000-63     | 1069    | 3.000 SCH. 40 | 3.500 | 3.068 | 0.216   | X    |      | 2.621  |
| P3000-61     | 1069    | 3.000 SCH. 40 | 3.500 | 3.068 | 0.216   |      | X    | 2.621  |
|              | 1124    | 3.000 SCH. 80 | 3.500 | 2.900 | 0.300   | X    |      | 3.547  |
|              | 1124    | 3.000 SCH. 80 | 3.500 | 2.900 | 0.300   |      | X    | 3.547  |
|              | 1099    | 3.500 SCH. 5  | 4.000 | 3.834 | 0.083   | X    |      | 1.201  |
|              | 1099    | 3.500 SCH. 5  | 4.000 | 3.834 | 0.083   |      | X    | 1.254  |
|              | 1100    | 3.500 SCH. 10 | 4.000 | 3.760 | 0.120   | X    |      | 1.755  |
|              | 1100    | 3.500 SCH. 10 | 4.000 | 3.760 | 0.120   |      | X    | 1.755  |
| P3500-63     | 1185    | 3.500 SCH. 40 | 4.000 | 3.548 | 0.226   | X    |      | 3.151  |
| P3500-61     | 1185    | 3.500 SCH. 40 | 4.000 | 3.548 | 0.226   |      | X    | 3.151  |
|              | 1174    | 4.000 SCH. 5  | 4.500 | 4.334 | 0.085   | X    |      | 1.415  |
|              | 1174    | 4.000 SCH. 5  | 4.500 | 4.334 | 0.085   |      | X    | 1.415  |
|              | 1111    | 4.000 SCH. 10 | 4.500 | 4.260 | 0.120   | X    |      | 1.942  |
|              | 1111    | 4.000 SCH. 10 | 4.500 | 4.260 | 0.120   |      | X    | 1.942  |
| P4000-63     | 1068    | 4.000 SCH. 40 | 4.500 | 4.026 | 0.237   | X    |      | 3.733  |
| P4000-61     | 1068    | 4.000 SCH. 40 | 4.500 | 4.026 | 0.237   |      | X    | 3.733  |
|              | 2299    | 4.000 SCH. 80 | 4.500 | 3.826 | 0.337   | X    |      | 5.183  |
|              | 2299    | 4.000 SCH. 80 | 4.500 | 3.826 | 0.337   |      | X    | 5.183  |
|              | 2297    | 5.000 SCH. 40 | 5.563 | 5.047 | 0.258   | X    |      | 5.057  |
|              | 2297    | 5.000 SCH. 40 | 5.563 | 5.047 | 0.258   |      | X    | 5.057  |
|              | 2298    | 5.000 SCH. 80 | 5.563 | 4.813 | 0.375   | X    |      | 7.188  |
|              | 2298    | 5.000 SCH. 80 | 5.563 | 4.813 | 0.375   |      | X    | 7.188  |
|              | 2136    | 6.000 SCH. 10 | 6.625 | 6.357 | 0.134   | X    |      | 3.213  |
|              | 2193    | 6.000 SCH. 40 | 6.625 | 6.065 | 0.280   | X    |      | 6.564  |
|              | 2193    | 6.000 SCH. 40 | 6.625 | 6.065 | 0.280   |      | X    | 6.564  |
|              | 2308    | 6.000 SCH. 80 | 6.625 | 5.761 | 0.432   | X    |      | 9.878  |
|              | 2308    | 6.000 SCH. 80 | 6.625 | 5.761 | 0.432   |      | X    | 9.878  |
|              | 2242    | 8.000 SCH. 10 | 8.625 | 8.329 | 0.148   | X    |      | 4.635  |
|              | 2291    | 8.000 SCH. 40 | 8.625 | 7.981 | 0.322   | X    |      | 9.878  |

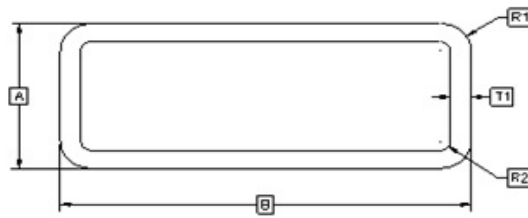

**Tri-City Extrusion, Inc.**

1610 Arkansas Avenue  
Bristol, TN 37620  
(Office) 866-242-9348  
(Fax) 866-242-9349

Description: Rectangular Tube (RECT)  
Alloy: 6000 Series

ASTM B221

| Depot Number | DIE NO. | DESCRIPTION   | A     | B     | T1    | R1    | R2    | WT/FT. |
|--------------|---------|---------------|-------|-------|-------|-------|-------|--------|
|              | 2281    | 0.689 X 1.689 | 0.689 | 1.689 | 0.156 | 0.016 | 0.016 | 0.779  |
|              | 1173    | 0.728 X 0.937 | 0.728 | 0.937 | 0.059 | 0.059 | 0.016 | 0.216  |
|              | 2227    | 0.750 X 1.500 | 0.750 | 1.500 | 0.125 | 0.016 | 0.016 | 0.600  |
|              | 1057    | .788 X 1.575  | 0.788 | 1.575 | 0.065 | 0.062 | 0.020 | 0.348  |
|              | 2621    | .788 X 1.575  | 0.788 | 1.575 | 0.065 | 0.062 | 0.020 | 0.348  |
|              | 1003    | 0.937 X 1.500 | 0.937 | 1.500 | 0.041 | 0.062 | 0.021 | 0.232  |
|              | 1004    | 0.937 X 2.000 | 0.937 | 2.000 | 0.040 | 0.125 | 0.619 | 0.275  |
|              | 1075    | 1.000 X 1.500 | 1.000 | 1.500 | 0.055 | 0.125 | 0.078 | 0.316  |
|              | 2444    | 1.000 X 1.500 | 1.000 | 1.500 | 0.125 | 0.016 | 0.016 | 0.632  |
|              | 1076    | 1.000 X 2.000 | 1.000 | 2.000 | 0.060 | 0.157 | 0.097 | 0.415  |
|              | 2621    | 1.000 X 2.000 | 1.000 | 2.000 | 0.062 | 0.016 | 0.016 | 0.415  |
|              | 2999    | 1.000 X 2.000 | 1.000 | 2.000 | 0.090 | 0.016 | 0.016 | 0.597  |
|              | 2282    | 1.000 X 2.000 | 1.000 | 2.000 | 0.093 | 0.063 | 0.016 | 0.625  |
|              | 2059    | 1.000 X 2.000 | 1.000 | 2.000 | 0.125 | 0.062 | 0.031 | 0.825  |
| RECT12-0125  | 2219    | 1.000 X 2.000 | 1.000 | 2.000 | 0.125 | 0.016 | 0.016 | 0.826  |
| RECT13-0125  | 1055    | 1.000 X 3.000 | 1.000 | 3.000 | 0.125 | 0.020 | 0.020 | 1.126  |
|              | 2154    | 1.000 X 3.000 | 1.000 | 3.000 | 0.125 | 0.250 | 0.125 | 1.076  |
|              | 2058    | 1.000 X 5.000 | 1.000 | 5.000 | 0.125 | 0.125 | 0.250 | 1.756  |
|              | 1059    | 1.102 X 1.575 | 1.102 | 1.575 | 0.080 | 0.062 | 0.020 | 0.483  |
|              | 2253    | 1.250 X 5.000 | 1.250 | 5.000 | 0.125 | 0.032 | 0.032 | 1.800  |
|              | 1079    | 1.372 X 4.500 | 1.372 | 4.500 | 0.120 | 0.025 | 0.015 | 1.622  |
|              | 2498    | 1.500 X 2.000 | 1.500 | 2.000 | 0.125 | 0.016 | 0.016 | 0.976  |
|              | 2290    | 1.500 X 2.000 | 1.500 | 2.000 | 0.125 | 0.125 | 0.125 | 0.960  |
| RECT15-0125  | 2304    | 1.500 X 2.500 | 1.500 | 2.500 | 0.125 | 0.125 | 0.016 | 1.110  |
|              | 2620    | 1.500 X 3.000 | 1.500 | 3.000 | 0.120 | 0.016 | 0.016 | 1.267  |
|              | 2563    | 1.500 X 3.000 | 1.500 | 3.000 | 0.125 | 0.016 | 0.016 | 1.274  |
|              | 1065    | 1.500 X 3.500 | 1.500 | 3.500 | 0.125 | 0.062 | 0.020 | 1.425  |



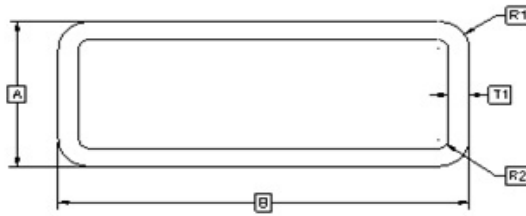

**Tri-City Extrusion, Inc.**

1610 Arkansas Avenue  
Bristol, TN 37620  
(Office) 866-242-9348  
(Fax) 866-242-9349

Description: Rectangular Tube (RECT)  
Alloy: 6000 Series

ASTM B221

| Depot Number | DIE NO. | DESCRIPTION    | A     | B      | T1    | R1    | R2    | WT/FT. |
|--------------|---------|----------------|-------|--------|-------|-------|-------|--------|
|              | 2191    | 1.750 X 3.000  | 1.750 | 3.000  | 0.125 | 0.016 | 0.016 | 1.350  |
|              | 2290    | 2.000 X 1.500  | 2.000 | 1.500  | 0.125 | 0.125 | 0.016 | 0.960  |
| RECT23-0125  | 1054    | 2.000 X 3.000  | 2.000 | 3.000  | 0.125 | 0.020 | 0.020 | 1.397  |
|              | 2171    | 2.000 X 3.000  | 2.000 | 3.000  | 0.188 | 0.016 | 0.016 | 2.082  |
|              | 2309    | 2.000 X 3.000  | 2.000 | 3.000  | 0.250 | 0.016 | 0.016 | 2.646  |
|              | 2481    | 2.000 X 3.000  | 2.000 | 3.000  | 0.250 | 0.250 | 0.250 | 2.651  |
| RECT24-0125  | 2039    | 2.000 X 4.000  | 2.000 | 4.000  | 0.125 | 0.015 | 0.016 | 1.691  |
|              | 2057    | 2.000 X 4.000  | 2.000 | 4.000  | 0.140 | 0.250 | N/A   | 1.902  |
|              | 2043    | 2.000 X 4.000  | 2.000 | 4.000  | 0.188 | 0.125 | 0.063 | 2.526  |
|              | 2174    | 2.000 X 4.000  | 2.000 | 4.000  | 0.250 | 0.016 | 0.016 | 3.234  |
|              | 2441    | 2.000 X 5.000  | 2.000 | 5.000  | 0.125 | 0.016 | 0.016 | 2.026  |
|              | 2153    | 2.000 X 5.000  | 2.000 | 5.000  | 0.188 | 0.016 | 0.016 | 2.982  |
|              | 2622    | 2.000 X 5.000  | 2.000 | 5.000  | 0.250 | 0.015 | 0.015 | 3.822  |
| RECT26-0125  | 2041    | 2.000 X 6.000  | 2.000 | 6.000  | 0.125 | 0.016 | 0.016 | 2.278  |
|              | 2176    | 2.000 X 6.000  | 2.000 | 6.000  | 0.188 | 0.016 | 0.016 | 3.432  |
|              | 2961    | 2.000 X 6.000  | 2.000 | 6.000  | 0.250 | 0.015 | 0.015 | 4.410  |
|              | 2775    | 2.000 X 12.000 | 2.000 | 12.000 | 0.125 | 0.015 | 0.015 | 4.043  |
|              | 2024    | 3.000 X 4.000  | 3.000 | 4.000  | 0.250 | 0.250 | 0.125 | 3.852  |
|              | 2052    | 3.000 X 6.000  | 3.000 | 6.000  | 0.250 | 0.250 | 0.250 | 5.101  |
|              | 2773    | 3.000 X 8.000  | 3.000 | 8.000  | 0.250 | 0.015 | 0.015 | 6.174  |
|              | 2053    | 4.000 X 2.000  | 4.000 | 2.000  | 0.250 | 0.188 | 0.188 | 3.234  |
|              | 2192    | 4.000 X 6.000  | 4.000 | 6.000  | 0.125 | 0.188 | 0.188 | 2.926  |
|              | 2027    | 4.000 X 6.000  | 4.000 | 6.000  | 0.188 | 0.015 | 0.016 | 4.331  |
|              | 2467    | 4.000 X 6.000  | 4.000 | 6.000  | 0.250 | 0.016 | 0.016 | 5.700  |



Tri-City Extrusion

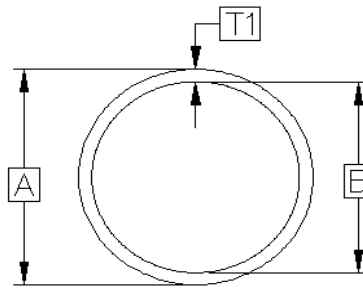

**Tri-City Extrusion, Inc.**

1610 Arkansas Avenue

Bristol, TN 37620

(Office) 866-242-9348

(Fax) 866-242-9349

Description: Round Tube

Alloy: 6000 Series

ASTM B429

| DIE NO. | DESCRIPTION      | OD<br>A | ID<br>B | WALL<br>T1 | WT/FT. |
|---------|------------------|---------|---------|------------|--------|
| 2225    | 0.438            | 0.438   | 0.272   | 0.083      | 0.110  |
| 1103    | 0.750 (16 gauge) | 0.750   | 0.626   | 0.062      | 0.161  |
| 2141    | 0.750            | 0.750   | 0.630   | 0.060      | 0.156  |
| 2283    | 0.840            | 0.840   | 0.528   | 0.156      | 0.402  |
| 1119    | 0.937            | 0.937   | 0.747   | 0.095      | 0.301  |
| 1179    | 0.940            | 0.940   | 0.730   | 0.105      | 0.331  |
| 1029I   | 1.000            | 1.000   | 0.750   | 0.125      | 0.398  |
| 1029R   | 1.015            | 1.015   | 0.755   | 0.130      | 0.434  |
| 2006    | 1.050            | 1.050   | 0.906   | 0.097      | 0.367  |
| 2060    | 1.250            | 1.250   | 1.124   | 0.063      | 0.282  |
| 2142    | 1.250            | 1.250   | 1.010   | 0.120      | 0.511  |
| 1199    | 1.312            | 1.312   | 0.688   | 0.312      | 1.176  |
| 2044    | 1.375            | 1.375   | 1.000   | 0.190      | 0.839  |
| 2072    | 1.500 (11 GAUGE) | 1.500   | 1.260   | 0.120      | 0.624  |
| 1121    | 1.500 (16 GAUGE) | 1.500   | 1.366   | 0.067      | 0.362  |
| 2116    | 1.500            | 1.500   | 1.340   | 0.080      | 0.428  |
| 1088    | 1.750            | 1.750   | 0.688   | 0.531      | 2.441  |
| 1198    | 1.750            | 1.750   | 1.125   | 0.313      | 1.693  |
| 1151    | 1.750 (14 GAUGE) | 1.750   | 1.582   | 0.084      | 0.528  |
| 1120    | 1.750 (16 GAUGE) | 1.750   | 1.616   | 0.067      | 0.425  |
| 2071    | 1.905            | 1.900   | 1.558   | 0.173      | 0.110  |
| 2034    | 1.900            | 1.900   | 1.776   | 0.062      | 0.453  |
| 1186    | 1.900            | 1.900   | 1.682   | 0.109      | 0.721  |



Tri-City Extrusion

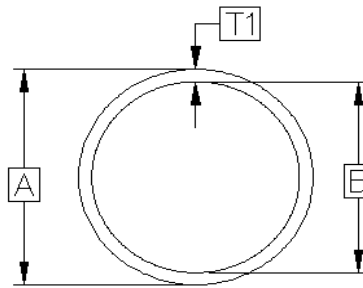

**Tri-City Extrusion, Inc.**

1610 Arkansas Avenue

Bristol, TN 37620

(Office) 866-242-9348

(Fax) 866-242-9349

Description: Round Tube

Alloy: 6000 Series

ASTM B429

| DIE NO. | DESCRIPTION      | OD<br>A | ID<br>B | WALL<br>T1 | WT/FT. |
|---------|------------------|---------|---------|------------|--------|
| 1117    | 2.000 (11 GAUGE) | 2.000   | 1.760   | 0.120      | 0.850  |
| 2691    | 2.000            | 2.000   | 1.750   | 0.125      | 0.883  |
| 1097    | 2.000 (14 GAUGE) | 2.000   | 1.832   | 0.084      | 0.607  |
| 1084    | 2.000 (16 GAUGE) | 2.000   | 1.866   | 0.067      | 0.488  |
| 2690    | 2.000            | 2.000   | 1.626   | 0.187      | 1.278  |
| 1122    | 2.125 (16 GAUGE) | 2.125   | 1.991   | 0.067      | 0.520  |
| 2223    | 2.127            | 2.127   | 1.969   | 0.079      | 0.610  |
| 1180    | 2.250 (11 GAUGE) | 2.251   | 2.010   | 0.120      | 0.964  |
| 1156    | 2.250 (14 GAUGE) | 2.250   | 2.082   | 0.084      | 0.686  |
| 1123    | 2.250 (16 GAUGE) | 2.250   | 2.116   | 0.067      | 0.551  |
| 2145    | 2.250            | 2.250   | 2.130   | 0.060      | 0.496  |
| 1187    | 2.375 (16 GAUGE) | 2.375   | 2.245   | 0.067      | 0.566  |
| 1104    | 2.500 (11 GAUGE) | 2.500   | 2.260   | 0.120      | 1.077  |
| 1105    | 2.500 (14 GAUGE) | 2.500   | 2.330   | 0.084      | 0.774  |
| 1089    | 2.500 (16 GAUGE) | 2.500   | 2.366   | 0.067      | 0.615  |
| 2146    | 2.500            | 2.500   | 2.334   | 0.083      | 0.756  |
| 1188    | 2.875 (14 GAUGE) | 2.875   | 2.709   | 0.084      | 0.875  |
| 1189    | 3.000            | 3.000   | 2.750   | 0.125      | 1.355  |
| 2147    | 3.000            | 3.000   | 2.610   | 0.095      | 1.040  |
| 1101    | 3.000 (14 GAUGE) | 3.000   | 2.830   | 0.084      | 0.935  |
| 1096    | 3.000 (16 GAUGE) | 3.000   | 2.866   | 0.067      | 0.740  |
| 2161    | 3.000            | 3.000   | 2.778   | 0.111      | 1.209  |
| 2185    | 3.000            | 3.000   | 2.624   | 0.188      | 1.993  |
| 2222    | 3.125            | 3.125   | 2.817   | 0.154      | 1.724  |
| 2224    | 3.433            | 3.433   | 3.125   | 0.154      | 1.903  |



Tri-City Extrusion

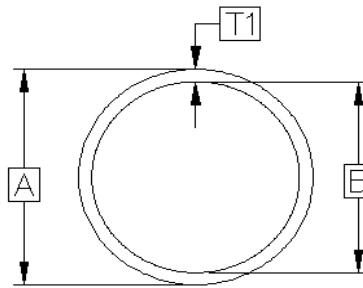

**Tri-City Extrusion, Inc.**

1610 Arkansas Avenue

Bristol, TN 37620

(Office) 866-242-9348

(Fax) 866-242-9349

Description: Round Tube

Alloy: 6000 Series

ASTM B429

| DIE NO.   | DESCRIPTION      | OD<br>A | ID<br>B | WALL<br>T1 | WT/FT. |
|-----------|------------------|---------|---------|------------|--------|
| 1129      | 3.500 (11 GAUGE) | 3.500   | 3.260   | 0.120      | 1.498  |
| 1190      | 3.500            | 3.500   | 3.250   | 0.125      | 1.590  |
| 1130      | 3.500 (14 GAUGE) | 3.500   | 3.334   | 0.084      | 1.048  |
| 1161      | 3.500 (16 GAUGE) | 3.500   | 3.366   | 0.067      | 0.867  |
| 2151      | 3.500            | 3.500   | 3.124   | 0.188      | 2.347  |
| 1098      | 4.000 (16 GAUGE) | 4.000   | 3.866   | 0.067      | 0.993  |
| 1099      | 4.000 (14 GAUGE) | 4.000   | 3.830   | 0.084      | 1.254  |
| 1100      | 4.000 (11 GAUGE) | 4.000   | 3.760   | 0.120      | 1.755  |
| 1191      | 4.000            | 4.000   | 3.750   | 0.125      | 1.823  |
| 1185      | 4.000            | 4.000   | 3.548   | 0.226      | 3.151  |
| 2133      | 4.000            | 4.000   | 3.688   | 0.156      | 2.261  |
| 2134      | 4.000            | 4.000   | 3.624   | 0.188      | 2.701  |
| 2149      | 4.000            | 4.000   | 3.500   | 0.250      | 3.534  |
| 2977      | 4.000            | 4.000   | 3.000   | 0.500      | 6.466  |
| 1174      | 4.500            | 4.500   | 4.330   | 0.085      | 1.415  |
| 1111      | 4.500 (11 GAUGE) | 4.500   | 4.260   | 0.120      | 1.981  |
| 1154      | 4.500            | 4.500   | 4.124   | 0.188      | 3.055  |
| HD4.5-250 | 4.500            | 4.500   | 4.000   | 0.250      | 4.006  |
| HD5-083   | 5.000            | 5.000   | 4.834   | 0.083      | 1.512  |
| HD5-120   | 5.000            | 5.000   | 4.760   | 0.120      | 2.207  |
| HD5-125   | 5.000            | 5.000   | 4.750   | 0.125      | 2.297  |
| HD5-156   | 5.000            | 5.000   | 4.688   | 0.156      | 2.849  |
| HD5-188   | 5.000            | 5.000   | 4.624   | 0.188      | 3.410  |
| HD5-250   | 5.000            | 5.000   | 4.500   | 0.250      | 4.477  |
| HD5.5-078 | 5.500            | 5.500   | 5.344   | 0.078      | 1.594  |



Tri-City Extrusion

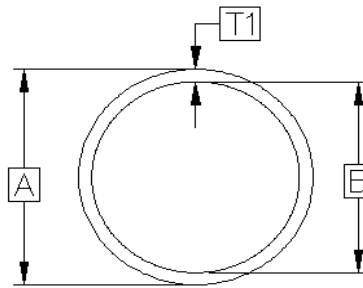

**Tri-City Extrusion, Inc.**

1610 Arkansas Avenue

Bristol, TN 37620

(Office) 866-242-9348

(Fax) 866-242-9349

Description: Round Tube

Alloy: 6000 Series

ASTM B429

| DIE NO. | DESCRIPTION | OD<br>A | ID<br>B | WALL<br>T1 | WT/FT. |
|---------|-------------|---------|---------|------------|--------|
| HD6-083 | 6.000       | 6.000   | 5.834   | 0.083      | 1.950  |
| HD6-093 | 6.000       | 6.000   | 5.814   | 0.093      | 2.070  |
| HD6-120 | 6.000       | 6.000   | 5.760   | 0.120      | 2.660  |
| HD6-125 | 6.000       | 6.000   | 5.750   | 0.125      | 2.768  |
| HD6-134 | 6.000       | 6.000   | 5.732   | 0.134      | 2.963  |
| HD6-156 | 6.000       | 6.000   | 5.688   | 0.156      | 3.437  |
| HD6-188 | 6.000       | 6.000   | 5.624   | 0.188      | 4.118  |
| HD6-195 | 6.000       | 6.000   | 5.610   | 0.195      | 4.267  |
| HD6-250 | 6.000       | 6.000   | 5.500   | 0.250      | 5.419  |
| 2300    | 6.000       | 6.000   | 5.374   | 0.313      | 6.576  |
| 2177    | 6.015       | 6.015   | 5.765   | 0.125      | 2.775  |
| 2301    | 6.550       | 6.550   | 5.650   | 0.450      | 10.141 |
| 2217    | 6.625       | 6.625   | 6.125   | 0.250      | 6.008  |
| 2193    | 6.625       | 6.625   | 6.065   | 0.280      | 6.698  |
| HD7-125 | 7.000       | 7.000   | 6.750   | 0.125      | 3.240  |
| HD7-156 | 7.000       | 7.000   | 6.688   | 0.156      | 4.026  |
| HD7-188 | 7.000       | 7.000   | 6.624   | 0.188      | 4.829  |
| HD7-219 | 7.000       | 7.000   | 6.562   | 0.219      | 5.599  |
| HD7-250 | 7.000       | 7.000   | 6.500   | 0.250      | 6.362  |
| HD8-125 | 8.000       | 8.000   | 7.750   | 0.125      | 3.710  |
| HD8-156 | 8.000       | 8.000   | 7.688   | 0.156      | 4.613  |
| HD8-188 | 8.000       | 8.000   | 7.624   | 0.188      | 5.536  |
| HD8-219 | 8.000       | 8.000   | 7.562   | 0.219      | 6.424  |
| HD8-250 | 8.000       | 8.000   | 7.500   | 0.250      | 7.303  |
| HD8-312 | 8.000       | 8.000   | 7.376   | 0.312      | 9.042  |
| HD8-375 | 8.000       | 8.000   | 7.250   | 0.375      | 10.780 |
| 2242    | 8.625       | 8.625   | 8.329   | 0.148      | 3.710  |

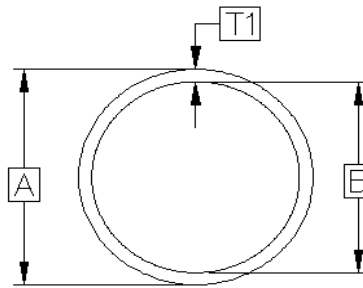

**Tri-City Extrusion, Inc.**

1610 Arkansas Avenue

Bristol, TN 37620

(Office) 866-242-9348

(Fax) 866-242-9349

Description: Round Tube

Alloy: 6000 Series

ASTM B429

| DIE NO.  | DESCRIPTION | OD<br>A | ID<br>B | WALL<br>T1 | WT/FT. |
|----------|-------------|---------|---------|------------|--------|
| HD9-156  | 9.000       | 9.000   | 8.688   | 0.156      | 5.201  |
| HD9-188  | 9.000       | 9.000   | 8.624   | 0.188      | 6.245  |
| HD9-219  | 9.000       | 9.000   | 8.562   | 0.219      | 7.249  |
| HD9-250  | 9.000       | 9.000   | 8.500   | 0.250      | 8.246  |
| HD9-375  | 9.000       | 9.000   | 8.250   | 0.375      | 12.193 |
| HD10-156 | 10.000      | 10.000  | 9.688   | 0.156      | 5.790  |
| HD10-165 | 10.000      | 10.000  | 9.670   | 0.165      | 5.995  |
| HD10-188 | 10.000      | 10.000  | 9.624   | 0.188      | 6.954  |
| HD10-219 | 10.000      | 10.000  | 9.562   | 0.219      | 8.486  |
| HD10-250 | 10.000      | 10.000  | 9.500   | 0.250      | 9.190  |
| HD10-312 | 10.000      | 10.000  | 9.376   | 0.312      | 11.806 |
| HD10-375 | 10.000      | 10.000  | 9.250   | 0.375      | 13.607 |
| HD12-250 | 12.000      | 12.000  | 11.500  | 0.250      | 11.074 |
| HD12-312 | 12.000      | 12.000  | 11.376  | 0.312      | 13.740 |
| HD12-375 | 12.000      | 12.000  | 11.250  | 0.375      | 16.434 |

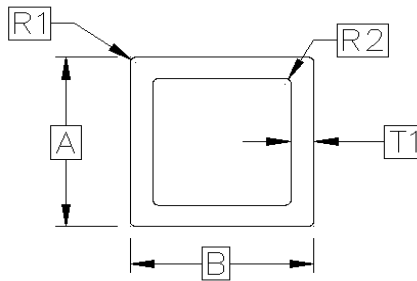

**Tri-City Extrusion, Inc.**

1610 Arkansas Avenue  
 Bristol, TN 37620  
 (Office) 866-242-9348  
 (Fax) 866-242-9349

Description: Square Tube (Sharp Corners and Radius Corners)  
 Alloy: 6000 Series

ASTM B221

| DEPOT NUMBER   | DIE NO. | DESCRIPTION | A     | B     | T1     | R1    | R2    | WT/FT. |
|----------------|---------|-------------|-------|-------|--------|-------|-------|--------|
| STSC-0750-0062 | 1108    | 0.750       | 0.750 | 0.750 | 0.062  | 0.015 | 0.015 | 0.204  |
|                | 1034    | 0.750       | 0.750 | 0.750 | 0.062  | 0.125 | 0.062 | 0.205  |
| STSC-0750-0125 | 1167    | 0.750       | 0.750 | 0.750 | 0.125  | 0.031 | 0.015 | 0.376  |
|                | 1085    | 0.875       | 0.875 | 0.875 | 0.040  | 0.157 | 0.117 | 0.148  |
|                | 1001    | 0.937       | 0.937 | 0.937 | 0.040  | 0.125 | 0.619 | 0.164  |
| STSC-1000-0062 | 2097    | 1.000       | 1.000 | 1.000 | 0.0625 | 0.015 | 0.015 | 0.282  |
|                | 2221    | 1.000       | 1.000 | 1.000 | 0.0900 | 0.125 | 0.016 | 0.378  |
|                | 2095    | 1.000       | 1.000 | 1.000 | 0.1000 | 0.156 | 0.056 | 0.402  |
|                | 2096    | 1.000       | 1.000 | 1.000 | 0.100  | 0.015 | 0.056 | 0.432  |
|                | 1074    | 1.000       | 1.000 | 1.000 | 0.040  | 0.157 | 0.078 | 0.184  |
|                | 1022    | 1.000       | 1.000 | 1.000 | 0.062  | 0.125 | 0.062 | 0.267  |
|                | 1021    | 1.000       | 1.000 | 1.000 | 0.125  | 0.125 | 0.016 | 0.526  |
| STSC-1000-0125 | 2079    | 1.000       | 1.000 | 1.000 | 0.125  | 0.015 | 0.015 | 0.525  |
|                | 2037    | 1.250       | 1.250 | 1.250 | 0.125  | 0.015 | 0.015 | 0.675  |
|                | 2056    | 1.300       | 1.300 | 1.300 | 0.125  | 0.125 | 0.125 | 0.703  |
|                | 1077    | 1.500       | 1.500 | 1.500 | 0.060  | 0.015 | 0.030 | 0.415  |
|                | 2618    | 1.500       | 1.500 | 1.500 | 0.090  | 0.016 | 0.016 | 0.628  |
| STSC-1500-0125 | 2218    | 1.500       | 1.500 | 1.500 | 0.125  | 0.016 | 0.016 | 0.826  |
|                | 2179    | 1.500       | 1.500 | 1.500 | 0.125  | 0.062 | 0.062 | 0.825  |
|                | 1162    | 1.500       | 1.500 | 1.500 | 0.125  | 0.125 | 0.016 | 0.809  |
|                | 2783    | 1.500       | 1.500 | 1.500 | 0.125  | 0.250 | 0.125 | 0.761  |
|                | 2551    | 1.500       | 1.500 | 1.500 | 0.250  | 0.015 | 0.015 | 1.500  |
|                | 2944    | 1.750       | 1.750 | 1.750 | 0.093  | 0.015 | 0.015 | 0.724  |
|                | 2197    | 1.750       | 1.750 | 1.750 | 0.100  | 0.375 | 0.275 | 0.725  |
|                | 2943    | 1.750       | 1.750 | 1.750 | 0.125  | 0.015 | 0.015 | 0.955  |
|                | 2619    | 2.000       | 2.000 | 2.000 | 0.060  | 0.016 | 0.016 | 0.576  |
|                | 2941    | 2.000       | 2.000 | 2.000 | 0.093  | 0.015 | 0.015 | 0.843  |
| STSC-2000-0125 | 2026    | 2.000       | 2.000 | 2.000 | 0.125  | 0.015 | 0.016 | 1.103  |

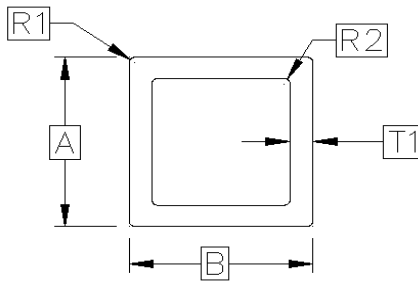

**Tri-City Extrusion, Inc.**

1610 Arkansas Avenue  
 Bristol, TN 37620  
 (Office) 866-242-9348  
 (Fax) 866-242-9349

Description: Square Tube (Sharp Corners and Radius Corners)  
 Alloy: 6000 Series

ASTM B221

| DEPOT NUMBER   | DIE NO. | DESCRIPTION | A     | B     | T1    | R1    | R2    | WT/FT. |
|----------------|---------|-------------|-------|-------|-------|-------|-------|--------|
|                | 2036    | 2.000       | 2.000 | 2.000 | 0.125 | 0.250 | 0.250 | 1.077  |
| STSC-2000-0188 | 2089    | 2.000       | 2.000 | 2.000 | 0.188 | 0.016 | 0.016 | 1.650  |
|                | 2078    | 2.000       | 2.000 | 2.000 | 0.250 | 0.015 | 0.016 | 2.100  |
|                | 2115    | 2.000       | 2.000 | 2.000 | 0.250 | 0.250 | 0.016 | 2.035  |
| STSC-2000-0250 | 2085    | 2.000       | 2.000 | 2.000 | 0.250 | 0.016 | 0.016 | 2.100  |
| STSC-3000-0125 | 2220    | 3.000       | 3.000 | 3.000 | 0.125 | 0.016 | 0.016 | 1.726  |
|                | 2784    | 3.000       | 3.000 | 3.000 | 0.125 | 0.250 | 0.125 | 1.682  |
|                | 2440    | 3.000       | 3.000 | 3.000 | 0.188 | 0.016 | 0.016 | 2.538  |
|                | 2025    | 3.000       | 3.000 | 3.000 | 0.250 | 0.250 | 0.125 | 3.234  |
| STSC-3000-0250 | 2293    | 3.000       | 3.000 | 3.000 | 0.250 | 0.016 | 0.016 | 3.234  |
|                | 2042    | 3.500       | 3.500 | 3.500 | 0.188 | 0.030 | 0.060 | 2.991  |
| STSC-4000-0125 | 2033    | 4.000       | 4.000 | 4.000 | 0.125 | 0.015 | 0.016 | 2.325  |
|                | 2321    | 4.000       | 4.000 | 4.000 | 0.188 | 0.016 | 0.016 | 3.440  |
|                | 2121    | 4.000       | 4.000 | 4.000 | 0.250 | 0.500 | 0.500 | 4.449  |
| STSC-4000-0250 | 2294    | 4.000       | 4.000 | 4.000 | 0.250 | 0.016 | 0.016 | 4.500  |
|                | 2969    | 4.000       | 4.000 | 4.000 | 0.375 | 0.015 | 0.015 | 6.395  |
|                | 2211    | 5.000       | 5.000 | 5.000 | 0.188 | 0.063 | 0.063 | 3.440  |
|                | 2322    | 5.000       | 5.000 | 5.000 | 0.188 | 0.016 | 0.016 | 4.343  |
|                | 2120    | 5.000       | 5.000 | 5.000 | 0.188 | 0.500 | 0.500 | 4.342  |
|                | 2119    | 5.000       | 5.000 | 5.000 | 0.250 | 0.500 | 0.500 | 5.700  |
|                | 2292    | 6.000       | 6.000 | 6.000 | 0.125 | 0.016 | 0.016 | 3.526  |
|                | 2323    | 6.000       | 6.000 | 6.000 | 0.188 | 0.016 | 0.016 | 5.245  |
|                | 2118    | 6.000       | 6.000 | 6.000 | 0.188 | 0.500 | 0.500 | 5.244  |
|                | 2028    | 6.000       | 6.000 | 6.000 | 0.250 | 0.015 | 0.016 | 6.900  |
|                | 2117    | 6.000       | 6.000 | 6.000 | 0.250 | 0.500 | 0.500 | 6.762  |
|                | 2243    | 6.625       | 6.625 | 6.625 | 0.250 | 0.500 | 0.500 | 7.650  |
|                | 2325    | 6.750       | 6.750 | 6.750 | 0.188 | 0.016 | 0.016 | 5.922  |
|                | 2663    | 8.000       | 8.000 | 8.000 | 0.188 | 0.016 | 0.016 | 7.050  |



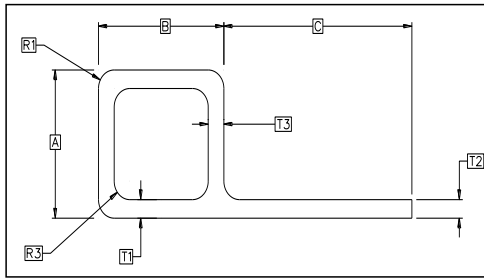

**Tri-City Extrusion, Inc.**

1610 Arkansas Avenue  
Bristol, TN 37620  
(Office) 866-242-9348  
(Fax) 866-242-9349

Description: Flange Tube  
Alloy: 6000 Series

ASTM B221

| DIE NO. | DESCRIPTION       | Tube Height<br>A | Tube Width<br>B | Flange Width<br>C | Tube Wall<br>T1 | Flange Wall<br>T2 | Tube Wall<br>T3 | Radius<br>R1 | Radius<br>R3 | WT/FT. |
|---------|-------------------|------------------|-----------------|-------------------|-----------------|-------------------|-----------------|--------------|--------------|--------|
| 1005M   | 0.937 TUBE W/.235 | 0.937            | 0.937           | 0.235             | 0.040           | 0.040             | 0.040           | 0.125        | 0.085        | 0.200  |
| 1005    | 0.937 TUBE W/.937 | 0.937            | 0.937           | 0.937             | 0.042           | 0.042             | 0.040           | 0.125        | 0.083        | 0.238  |
| 2106    | 2.00 TUBE W/1.500 | 2.000            | 2.000           | 1.500             | 0.125           | 0.137             | 0.125           | 0.125        | 0.030        | 1.330  |

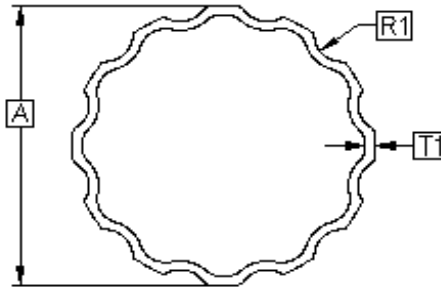

**Tri-City Extrusion, Inc.**

1610 Arkansas Avenue

Bristol, TN 37620

(Office) 866-242-9348

(Fax) 866-242-9349

Description: Fluted Tube

ASTM B221

Alloy: 6000 Series

| DIE NO. | DESCRIPTION | OD<br>A | No. of<br>Flutes | WALL<br>T1 | Radius of<br>Flute R1 | WT/FT. |
|---------|-------------|---------|------------------|------------|-----------------------|--------|
| 2201    | 4.000       | 4.000   | 12               | 0.125      | 0.375                 | 2.009  |
| 2168    | 4.000       | 4.000   | 12               | 0.188      | 0.375                 | 2.903  |
| 2200    | 5.000       | 5.000   | 12               | 0.125      | 0.625                 | 2.351  |
| 2209    | 5.000       | 5.000   | 12               | 0.188      | 0.375                 | 4.335  |
| 2208    | 6.000       | 6.000   | 12               | 0.125      | 0.750                 | 2.832  |
| 2199    | 6.000       | 6.000   | 12               | 0.188      | 0.750                 | 4.211  |
| 2207    | 6.000       | 6.000   | 12               | 0.250      | 0.750                 | 7.038  |

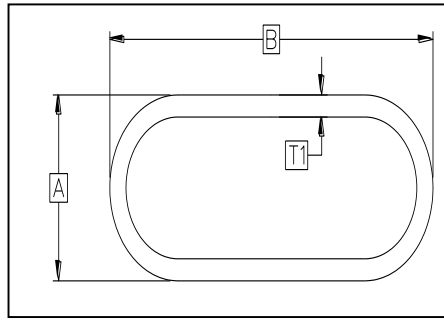

**Tri-City Extrusion, Inc.**

1610 Arkansas Avenue  
Bristol, TN 37620  
(Office) 866-242-9348  
(Fax) 866-242-9349

Description: Oval Tube  
Alloy: 6000 Series

ASTM B221

| DIE NO. | DESCRIPTION   | A      | B     | T1    | WT/FT. |
|---------|---------------|--------|-------|-------|--------|
| 1192    | 1.250 X 4.000 | 1.2500 | 4.000 | 0.125 | 1.500  |

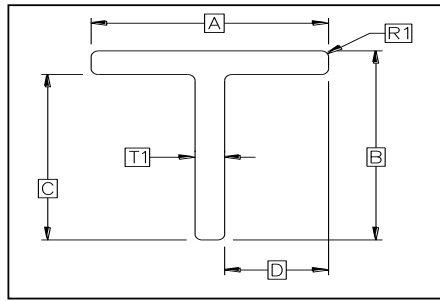

**Tri-City Extrusion, Inc.**

1610 Arkansas Avenue  
Bristol, TN 37620  
(Office) 866-242-9348  
(Fax) 866-242-9349

Description: T Bar  
Alloy: 6000 Series

ASTM B221

| DIE NO. | DESCRIPTION | A     | B     | C     | D     | T1    | R1    | WT/FT. |
|---------|-------------|-------|-------|-------|-------|-------|-------|--------|
| 50447   | 2.000       | 2.000 | 4.000 | 3.750 | 0.875 | 0.250 | 0.016 | 1.724  |
| 50512   | 2.000       | 2.000 | 5.000 | 4.625 | 0.813 | 0.375 | 0.016 | 2.981  |
| 50445   | 2.000       | 2.000 | 5.000 | 4.750 | 0.875 | 0.250 | 0.016 | 2.024  |
| 50446   | 2.000       | 2.000 | 6.000 | 5.265 | 0.813 | 0.375 | 0.016 | 3.431  |
| 376     | 3.000       | 3.000 | 4.000 | 3.750 | 1.344 | 0.312 | 0.125 | 2.306  |

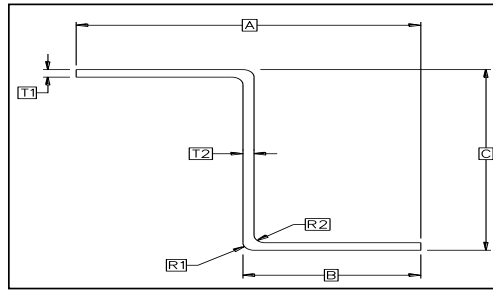

**Tri-City Extrusion, Inc.**

1610 Arkansas Avenue

Bristol, TN 37620

(Office) 866-242-9348

(Fax) 866-242-9349

Description: Z - Bar  
Alloy: 6000 Series

ASTM B221

| DIE NO. | DESCRIPTION | A     | B     | C     | T1    | T2    | R1    | R2    | WT/FT. |
|---------|-------------|-------|-------|-------|-------|-------|-------|-------|--------|
| 51003   | 1.750       | 3.313 | 1.750 | 1.750 | 0.187 | 0.187 | 0.016 | 0.250 | 1.085  |
| 50128   | 2.000       | 2.875 | 1.500 | 2.000 | 0.125 | 0.125 | 0.016 | 0.016 | 0.712  |
| 50803   | 5.000       | 6.500 | 3.250 | 5.000 | 0.125 | 0.312 | 0.016 | 0.312 | 4.090  |